

# *ESAB CaB 300M*

## *A Modularised Column and Boom for integrated weld mechanization*

### Today's industry

Due to the increased productivity demands, and the increased request of customised solutions, the CaB 300M has been developed.

To be able to meet the demands, and adjust to the needs of the industry many times a customised solution could be the only way.

With ESAB CaB configuration, the M-model gives the opportunity to build a customised solution with adapted modulus for different needs. All the functions are built in to the remote control, giving a fully integrated package.

### Flexible design

A robust and stable design together with an adapted integrated electrical design has given a flexible design. There are three options of foundation; steel plate, concrete stand and rail carriage. The column is eccentric to keep the welding head in centre of the base. The boom is driven by rack and pinion and the tachometer gives a stable and smooth motion.

The hoisting of the boom is done by a motor on top of the column and with help of a counter balance weight inside the column.

Both the lifting chain and the hoisting motor has a high and reliable safety factor. It is also supplied with a safety mechanism that in an event of a break down immediately locks the boom to prevent damage to both personnel and equipment.



CaB 300M

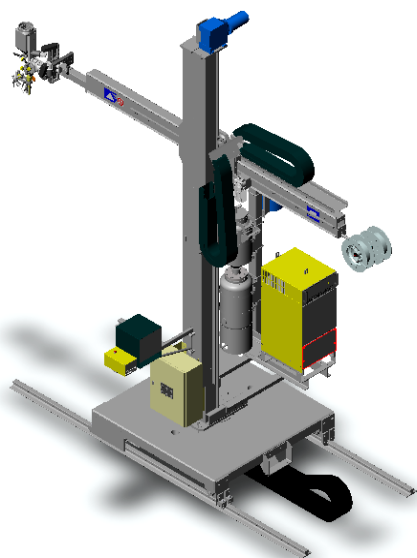

### Individual solutions

When dressing up the naked column and boom into a complete welding solution, the optional combinations are almost unlimited.

In order to facilitate the selection process to result in a specification based on customer's application, there is a computer aided configuration system available. Together with the ESAB representative the customer is able to build up his welding solution, i.e. a specification of the modular components to be assembled and installed at the customer's workshop in a most convenient manner.

For all modular components applicable for this column and boom, kindly refer to our range of leaflets available from our representative.

## Technical data, Column

Effective working range (m)	3	4	5
Boom height <b>A</b> (max mm)	4070	5070	6070
using movable carriage (min mm)	930	930	930
Boom height <b>B</b> (max mm)	3955	4955	5955
using concrete stand (min mm)	815	815	815
Boom height <b>C</b> (max mm)	3750	4750	5750
using stationary foot plate (min mm)	610	610	610
Total height <b>D</b> (mm)			
using movable carriage	5170	6170	7170
Total height <b>E</b> (mm)			
using concrete stand	5055	6055	7055
Total height <b>F</b> (mm)			
using stationary foot plate	4850	5850	6850
Lifting speed (m/min)	0.7	0.7	0.7
Total load on column platform (max kg)	600	600	600

## Technical data, Boom

Effective working range (m)	3	4	5
Extension <b>G</b> (max mm)	3580	4580	5580
(min mm)	540	540	540
Permissible loads			
-total (max kg)	300	220	150
-one end (max kg)	240	150	75
Cross-sectional diameter <b>H</b> (mm)	325	325	325
Welding speed (m/min)	0.1-2.0	0.1-2.0	0.1-2.0
Transport speed (m/min)	2.0	2.0	2.0

## Technical data, Concrete rail carriage

Track width <b>L</b> , inside to inside (mm)	1730 (standard)
Width x length (mm)	2060x2330
Height <b>I</b> (mm)	365
Welding speed (m/min)	0.1-2.0
Transport speed (m/min)	2.0
Total weight (kg)	1670

## Technical data, Concrete stand

Width x length (mm)	2060x2100
Height <b>J</b> (mm)	250
Total weight (kg)	1550

## Technical data, Steel plate

Width x length (mm)	1100x1100
Height <b>K</b> (mm)	40
Total weight (kg)	350

## Ordering information

Working range	Rail carriage Part no.	Stationary Part no.	Steel plate mounted Part No.
3x3	0810 422 884	0810 422 904	0810 422 924
4x4	0810 422 886	0810 422 906	0810 422 926
5x5	0810 422 888	0810 422 908	0810 422 928

### Prepared for camera:

3x3	0810 422 944	0810 422 964	0810 422 984
4x4	0810 422 946	0810 422 966	0810 422 986
5x5	0810 422 948	0810 422 968	0810 422 988

Other combinations of working ranges and foundations on request.

**Adapted modules:** Motorised rotation, pneumatic brake, shift function boom - slide travel, warning light, 4 WD, operator chair, ladder for column hoist inspection.

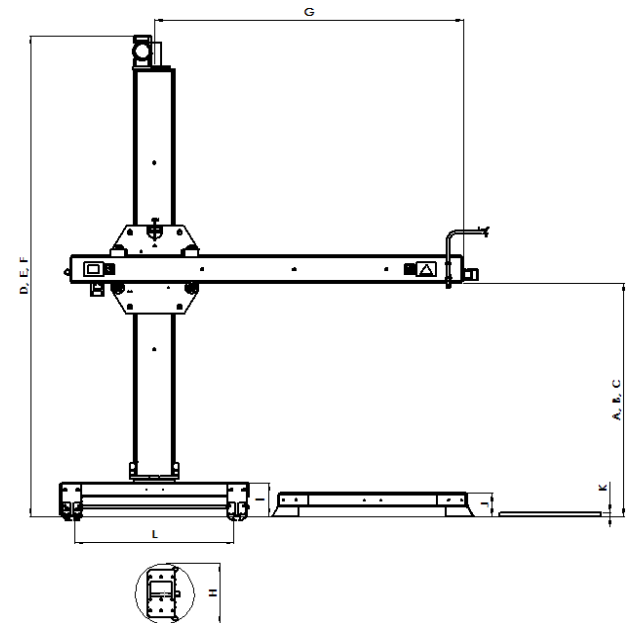

## CaB 300M

There are that many alternatives and options available to choose among in order to compose your welding station as per your individual need. To facilitate this composition we have created a configurator tool by means of which you together with our representative conveniently can procure the correct tailor-made station.

### Make a choice of:

<b>Foundations:</b>	Concrete rail carriage, Concrete stand, Steel plate
<b>Track widths:</b>	1340-1820 mm
<b>Drive units:</b>	2 or 4 Wheel Drive
<b>Tacho controls:</b>	Rail carriage, boom and wire feed
<b>Joint trackings:</b>	PAV or GMH
<b>Welding heads:</b>	A2S, A6S, twin or single, SAW or GMAW
<b>Power sources:</b>	LAF 635, TAF 800, LAF 1000, LAF/TAF 1250 and LAF 1600 incl. welding cables 95 mm <sup>2</sup> or 120 mm <sup>2</sup>
<b>Platform:</b>	Single
<b>Wire equipments:</b>	1-2x30 kg front or rear mounted
<b>Flux handlings:</b>	OPC Super, FFRS Super or FFRS 1200 Air dryer CRE, TPC 75 with or without heaters and level indicator, Tedak filter
<b>Camera systems:</b>	SAW or GMAW

and more...



**ESAB AB**  
Welding Equipment  
SE-695 81 LAXÅ SWEDEN  
Phone: +46 584 81000  
Fax: +46 584 411721  
E-mail: info@esab.se

[www.esab.com](http://www.esab.com)

